

CONTRACTOR(S) SHALL VERIFY EXISTING CONDITIONS AND CORRELATE DIMENSIONS PRIOR TO PROVIDING THE WORK DETAILED IN THESE DRAWINGS, AND SHALL PROMPTLY NOTIFY THE DESIGNER OF ANY DISCREPANCIES. IT IS A VIOLATION OF THE LAW FOR ANY PERSON, UNLESS ACTING UNDER THE DIRECTION OF A LICENSED ARCHITECT TO ALTER THESE PLANS AND SPECIFICATIONS. THIS DOCUMENT CONTAINS PROPERTY INFORMATION AND SHALL NOT BE USED OR REPRODUCED, IN WHOLE OR IN PART, WITHOUT THE PRIOR WRITTEN CONSENT OF GALLO HERBERT ARCHITECTS.

COPYRIGHT © 2024 GALLO HERBERT ARCHITECTS

E

D

C

B

A

1 GROUND FLOOR PLAN

3/32" = 1'-0"

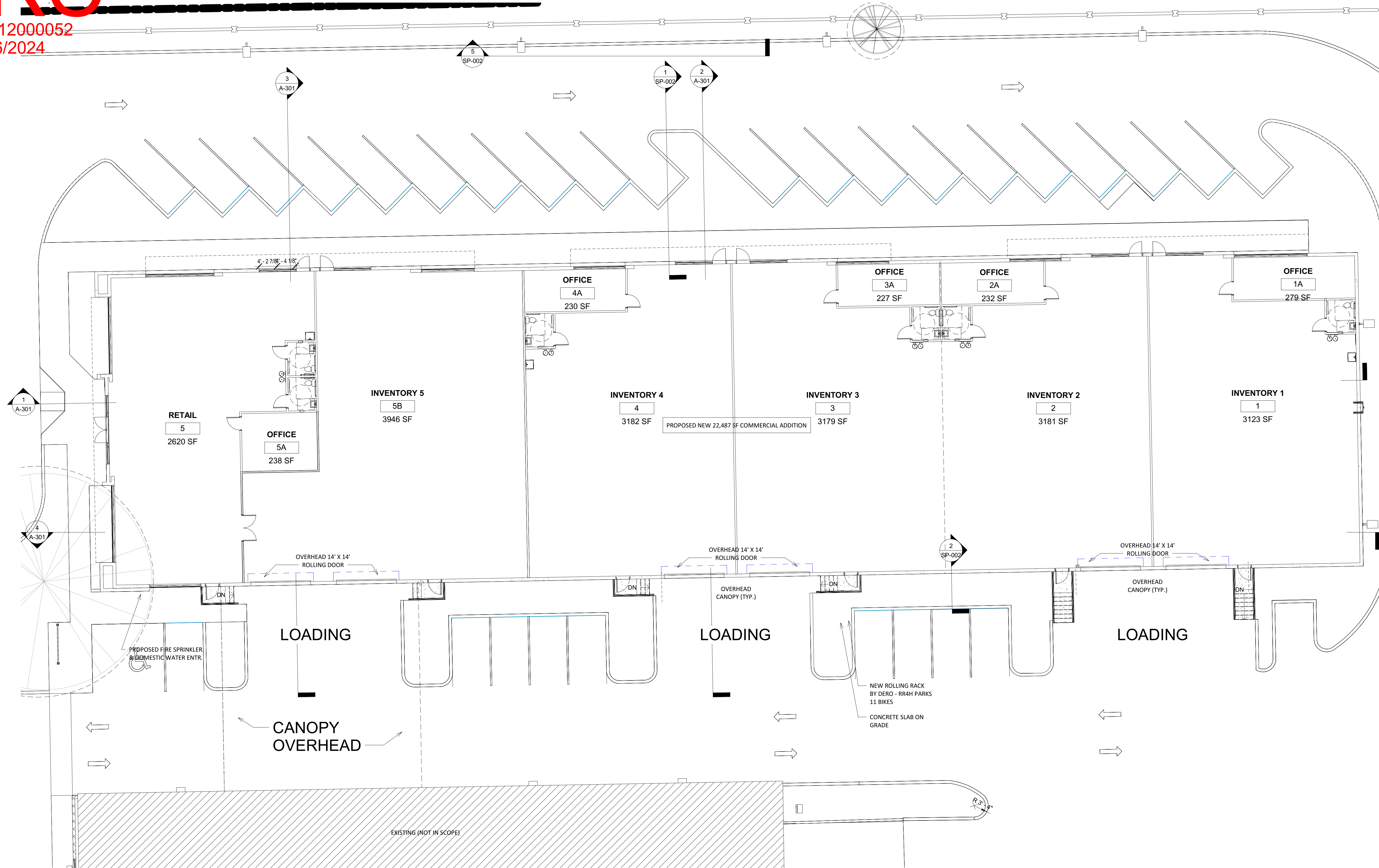
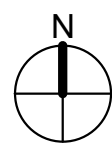

AA26001731

SEAL

WILLIAM J. GALLO FL AR0008440

Digitally signed by Brian Herbert  
Date: 2024.09.17 10:54:14 -0400

BRIAN P. HERBERT FL AR0015474

PROJECT

FIBERBUILT UMBRELLA

2201 LLC

2201 WEST ATLANTIC BLVD  
POMPANO BEACH, FL 33069

OWNER



REVISIONS

No.	Description	Date
1	DRC comments	09/26/23

PROJECT STATUS

SCHEMATIC DESIGN

DATE

Aug. 30, 2021

PROJECT NUMBER

2321

SCALE

DRAWN BY: N.V.A. CHECK BY: J.E.T.

DRAWING TITLE

ARCHITECTURAL FLOOR PLAN

DRAWING NUMBER

A-101